

Bypass Wedges & Parts

Bypass Wedges & Parts

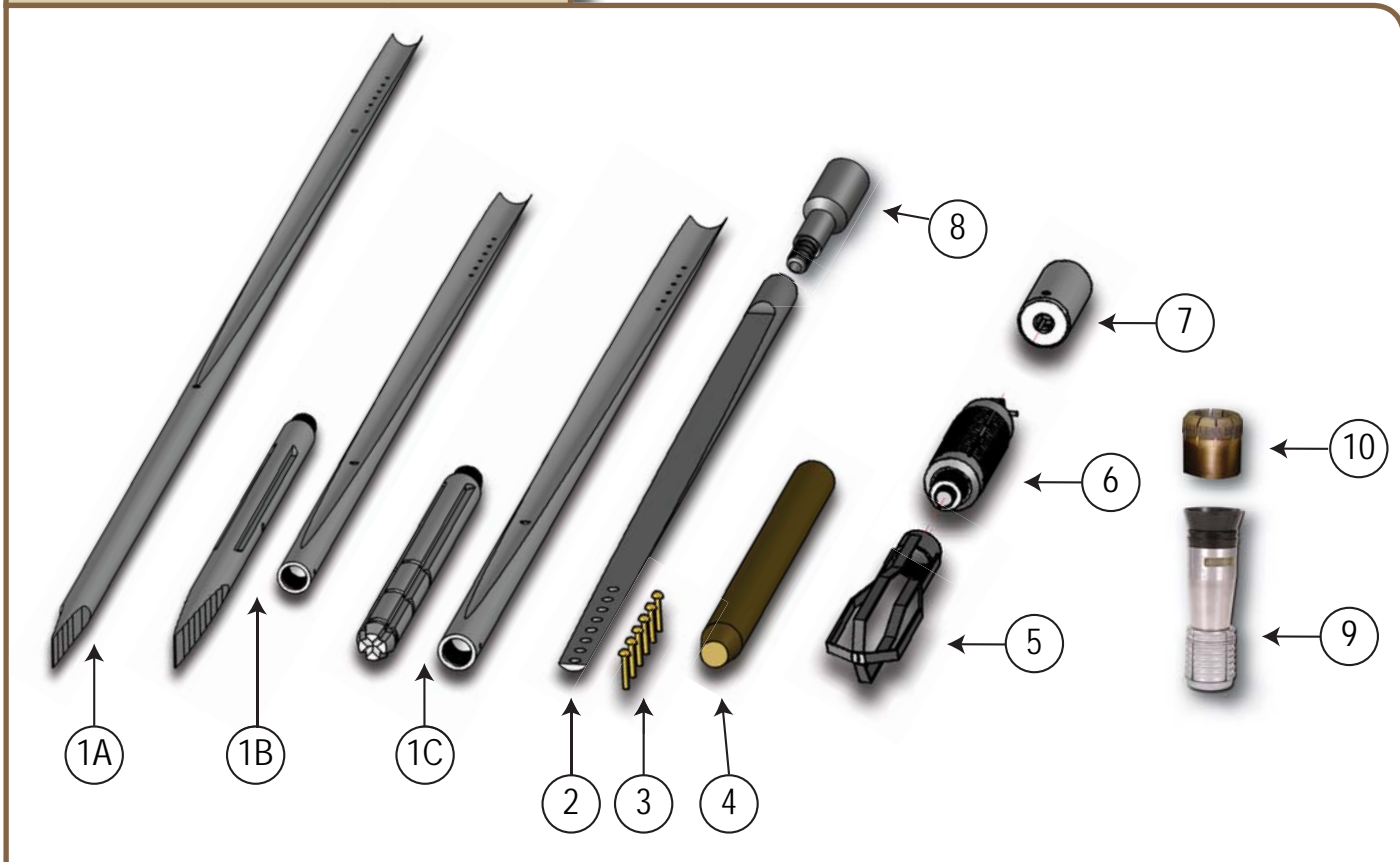

Number	Description	Product Number		
		"B"	"N"	"H"
Bypass Wedge Assemblies (Items 1-7)		90-09-300	90-09-400	90-09-500
1A	Bypass Chisel Wedge	595-00	596-00	597-00
1B	Bypass 2 Piece Chisel Wedge	595-00MAXE	596-00MAXE	597-00MAXE
1C	Bypass 2 Piece Blunt Wedge	595-00MGV	596-00MGV	597-00MGV
2	Wedge Dropper	595-01	596-01	597-01
3	Copper Rivets, 5/16 X 2"	92-1008	92-1008	92-1008
4	Wooden Plug	595-03	596-03	597-03
5	Steel Plug Basket	595-05	596-05	597-05
6	Wedge Plug with Pin	595-06	596-06	597-06
7	Rod Box to Wedge Plug Adapter	595-07	596-07	597-07
Items Not Included in Assembly - Supplied by TIME				
8	Wedge Dropper Adapter	93-55-302	93-55-403	93-55-503
9	Van Ruth Plug	409-01	409-03	409-02
10	Tapered Wedge Bit	PLT-WDG-B	PLT-WDG-N	PLT-WDG-H
11	Resin Epoxy	420-121		

When ordering TIME Limited's Bypass Wedge assemblies, you will need to choose either Wedge 1A, 1B, or 1C. You will need 1 each of items 2, 3, 4 and 8. Then you need to choose plug option 'A' (items 5, 6, 7) or plug option 'B' (item 9).

