

# Drilling Wedges - H Retrievable

**Assembly Diagram**  
**H - Retrievable Wedge**

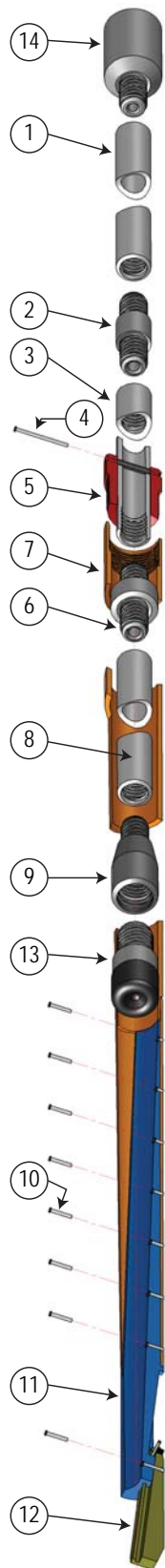

## H - Retrievable Wedge Assembly

Full Assembly Part / 90-10-500 (Items 1 through 12)

TIME Limited's Retrievable Wedge assemblies are manufactured in Canada with 4140 steel, a heat treated, stress relieved material, to ensure the best quality product.

### Why do we use retrievable Wedges?

- Ideal for drill holes that need multiple wedge deflections
- Can be used directly off the bottom of the drill hole
- No steel is left at the bottom of the hole
- Reusable

**Before you use the assembly, ensure the bottom of the hole is flat by using the Solid Spindle Assembly and Dressing bit (not shown).**

H Solid Spindle Assembly	629-14
H Inner Tube Dressing Bit	627-16

### Using a Retrievable Wedge

- Lower wedge to the bottom of the hole
- Shear the pin on the locking wedge
- Shear the pin on the retrieving coupling
- Drill the concave bit passed the wedge blade
- Remove the entire wedge assembly by pulling the rods

To ensure the wedge assembly drills in the correct hole and follows the wedge deflection, drillers should not be overly cautious. It is recommended that the penetration rate and rotation speed be as fast as possible whilst operating within smooth drilling practices according to ground conditions. If the penetration rate is too slow the bit will tend to have a milling effect on the wedge increasing the possibility of drilling it out and not gaining the required amount of deflection.

Item	Qty	Description / Material	Size/Pt. No
1	1	10' BW Drill Rod (less coupling)	91-10-310
2	1	BW Rod Coupling	91-10-319
3	1	Wedging Barrel (2ft BW Rod)	629-07
4	1	Shear Pin, 5" Common Nail	625-49
5	1	Wedge Housing Collar	629-04
6	1	Retrieving Coupling	629-08
7	1	Wedge Housing	629-03
8	1	5' BW Drill Rod (less coupling)	91-10-305
9	1	Tapered Sub	629-09
10	8	Shear Pin, 4" Common Nail	625-50
11	1	Wedge Blade	629-00
12	1	Locking Wedge	629-01

The following items are not included in the assembly, but are supplied by TIME

13	1	NWC Concave Bit	629-13
14 A	1	Sub, HWL Rod Box to BW Rod Pin	93-55-502
14 B	1	Sub, HT Rod Box to BW Rod Pin	93-55-512

