

# Drilling Wedges

WE - Drilling Wedges



North America 1-800-669-3542  
International +1-705-647-8138  
PAGE: WE1



[www.time ltd.ca](http://www.time ltd.ca)

# Drilling Wedges - B Retrievable

## Assembly Diagram B - Retrievable Wedge

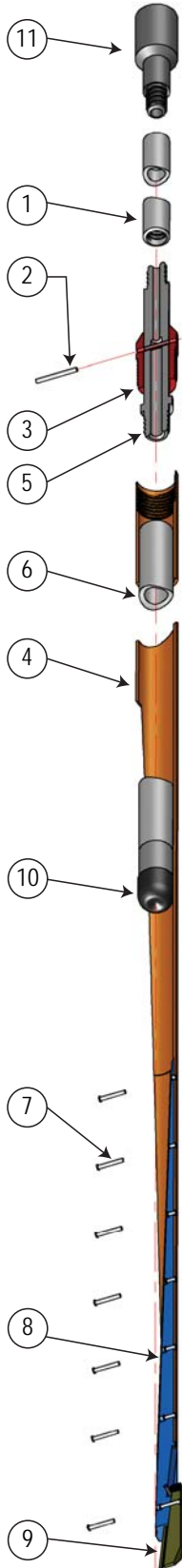

## B - Retrievable Wedge Assembly Full Assembly Part / 90-10-300 (Items 1 through 9)

TIME Limited's Retrievable Wedge assemblies are manufactured in Canada with 4140 steel, a heat treated, stress relieved material, to ensure the best quality product.

### Why do we use retrievable Wedges?

- Ideal for drill holes that need multiple wedge deflections
- Can be used directly off the bottom of the drill hole
- No steel is left at the bottom of the hole
- Reusable

**Before you use the assembly, ensure the bottom of the hole is flat by using the Solid Spindle Assembly and Dressing bit (not shown).**

B Solid Spindle Assembly	625-51
B Inner Tube Dressing Bit	627-15

### Using a Retrievable Wedge

- Lower wedge to the bottom of the hole
- Shear the pin on the locking wedge
- Shear the pin on the retrieving coupling
- Drill the concave bit passed the wedge blade
- Remove the entire wedge assembly by pulling the rods

To ensure the wedge assembly drills in the correct hole and follows the wedge deflection, drillers should not be overly cautious. It is recommended that the penetration rate and rotation speed be as fast as possible whilst operating within smooth drilling practices according to ground conditions. If the penetration rate is too slow the bit will tend to have a milling effect on the wedge increasing the possibility of drilling it out and not gaining the required amount of deflection.

Item	Qty	Description / Material	Size/Pt. No
1	1	10' EW Drill Rod (less coupling)	91-10-110
2	1	Shear Pin, 5" Common Nail	625-49
3	1	Wedge Housing Collar	594-05
4	1	Wedge Housing	594-07
5	1	Retrieving Coupling	594-06
6	1	6' AW Drill Rod (less coupling)	91-10-206
7	7	Shear Pin, 4" Common Nail	625-50
8	1	Wedge Blade	594-15
9	1	Locking Wedge	594-16

The following items are not included in the assembly, but are supplied by TIME

10	1	AWC Concave Bit	627-11
11A	1	Sub, BWL Rod Box to EW Rod Pin	93-55-300
11B	1	Sub, BT Rod Box to EW Rod Pin	93-55-310



# Drilling Reamer - B Retrievable

## Assembly Diagram B - Retrievable Reamer

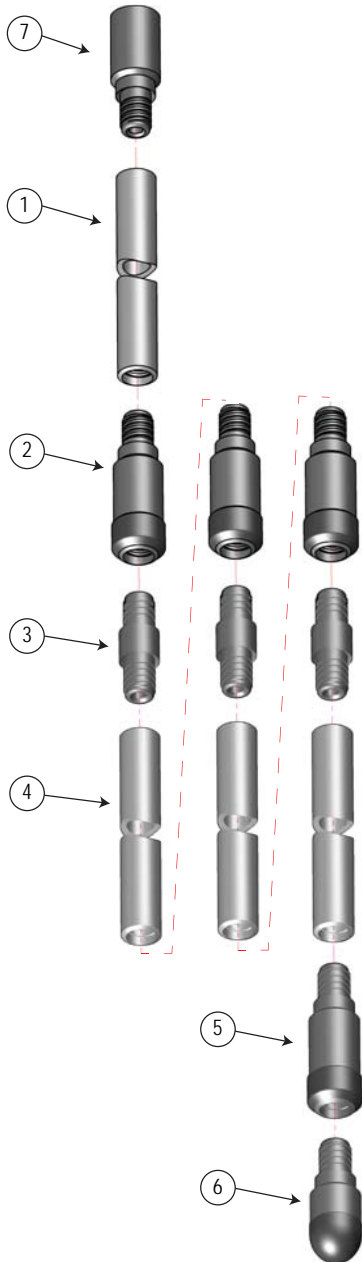

## B - Retrievable Reamer Assembly Full Assembly Part / 90-11-300 (Items 1 through 6)

TIME Limited's Retrievable Wedge assemblies are manufactured in Canada with 4140 steel, a heat treated, stress relieved material, to ensure the best quality product.

### Why do we use a reamer assembly?

- Ensures a smooth transition from the parent hole to the wedge deflection
- Ensures a smooth deflection in the drill hole
- Ensures hole is at the proper gauge diameter to continue coring
- Reusable

### Using a Retrievable Reamer

To ensure the reamer assembly functions properly, it is recommended that the penetration rate and rotation speed be as fast as possible whilst operating within smooth drilling practices according to ground conditions. Additional bit pressure may be required to force the bull-nose bit and reamer assembly into the new hole.

Item	Qty	Description / Material	Size/Pt. No
1	1	5' AW Drill Rod (less coupling)	91-10-205
2	3	BAWC Reaming Bit	627-10
3	3	AW Rod Coupling	91-10-219
4	3	2' AW Drill Rod (less coupling)	91-10-202
5	1	BAWC Reaming Shell	627-12
6	1	BAWC Ball Bit	627-13
The following items are not included in the assembly, but are supplied by TIME			
7A	1	Sub, BWL Rod Box to AW Rod Pin	93-55-301
7B	1	Sub, BT Rod Box to AW Rod Pin	93-55-311

Please Note: TIME will make adapters to fit your thread specifications



# Drilling Wedges - N Retrievable

## Assembly Diagram N - Retrievable Wedge

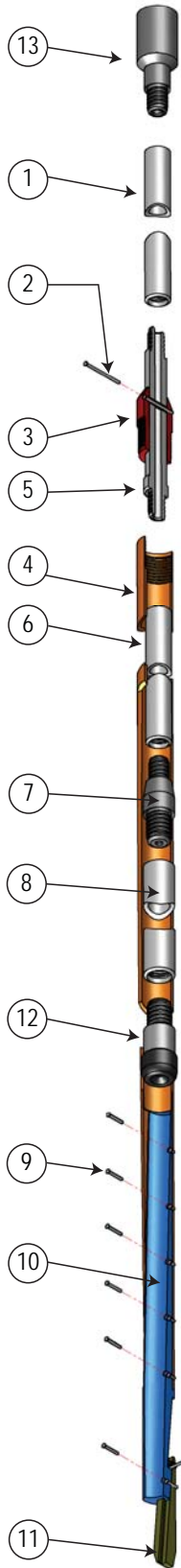

## N - Retrievable Wedge Assembly Full Assembly Part / 90-10-400 (Items 1 through 11)

TIME Limited's Retrievable Wedge assemblies are manufactured in Canada with 4140 steel, a heat treated, stress relieved material, to ensure the best quality product.

### Why do we use retrievable Wedges?

- Ideal for drill holes that need multiple wedge deflections
- Can be used directly off the bottom of the drill hole
- No steel is left at the bottom of the hole
- Reusable

**Before you use the assembly, ensure the bottom of the hole is flat by using the Solid Spindle Assembly and Dressing bit (not shown).**

N Solid Spindle Assembly	625-52
N Inner Tube Dressing Bit	627-14

### Using a Retrievable Wedge

- Lower wedge to the bottom of the hole
- Shear the pin on the locking wedge
- Shear the pin on the retrieving coupling
- Drill the concave bit passed the wedge blade
- Remove the entire wedge assembly by pulling the rods

To ensure the wedge assembly drills in the correct hole and follows the wedge deflection, drillers should not be overly cautious. It is recommended that the penetration rate and rotation speed be as fast as possible whilst operating within smooth drilling practices according to ground conditions. If the penetration rate is too slow the bit will tend to have a milling effect on the wedge increasing the possibility of drilling it out and not gaining the required amount of deflection.

Item	Qty	Description / Material	Size/Pt. No
1	1	10' AW Drill Rod (less coupling)	91-10-210
2	1	Shear Pin, 5" Common Nail	625-49
3	1	Wedge Housing Collar	625-08
4	1	Wedge Housing	625-11
5	1	Retrieving Coupling	625-09
6	1	4' AW Drill Rod (less coupling)	91-10-204
7	1	Tapered Sub	625-07
8	1	1' BW Drill Rod (less coupling)	91-10-301
9	6	Shear Pin, 4" Common Nail	625-50
10	1	Wedge Blade	625-14
11	1	Locking Wedge	625-15

The following items are not included in the assembly, but are supplied by TIME

12	1	BWC Concave Bit	627-00
13A	1	Sub, NWL Rod Box to AW Rod Pin	93-55-401
13B	1	Sub, NT Rod Box to AW Rod Pin	93-55-411



# Drilling Reamer - N Retrievable

## Assembly Diagram N - Retrievable Reamer

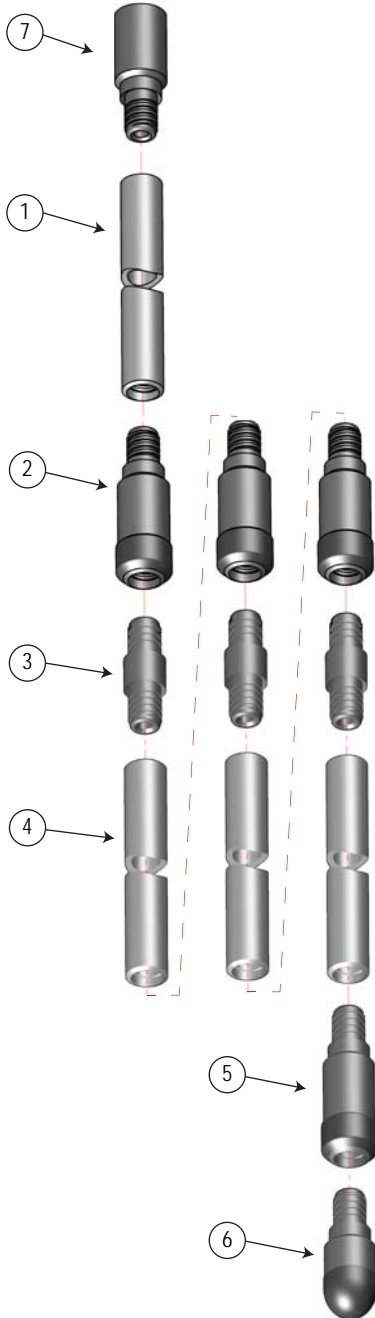

## N - Retrievable Reamer Assembly Full Assembly Part / 90-11-400 (Items 1 through 6)

TIME Limited's Retrievable Wedge assemblies are manufactured in Canada with 4140 steel, a heat treated, stress relieved material, to ensure the best quality product.

### Why do we use a reamer assembly?

- Ensures a smooth transition from the parent hole to the wedge deflection
- Ensures a smooth deflection in the drill hole
- Ensures hole is at the proper gauge diameter to continue coring
- Reusable

### Using a Retrievable Reamer

To ensure the reamer assembly functions properly, it is recommended that the penetration rate and rotation speed be as fast as possible whilst operating within smooth drilling practices according to ground conditions. Additional bit pressure may be required to force the bull-nose bit and reamer assembly into the new hole.

Item	Qty	Description / Material	Size/Pt. No
1	1	5' BW Drill Rod (less coupling)	91-10-305
2	3	NBWC Reaming Bit	627-02
3	3	BW Rod Coupling	91-10-319
4	3	2' BW Drill Rod (less coupling)	91-10-302
5	1	NBWC Reaming Shell	627-03
6	1	NBWC Ball Bit	627-01
The following items are not included in the assembly, but are supplied by TIME			
7A	1	Sub, NWL Rod Box to BW Rod Pin	93-55-402
7B	1	Sub, NT Rod Box to BW Rod Pin	93-55-412

Please Note: TIME will make adapters to fit your thread specifications



# Drilling Wedges - H Retrievable

## Assembly Diagram H - Retrievable Wedge

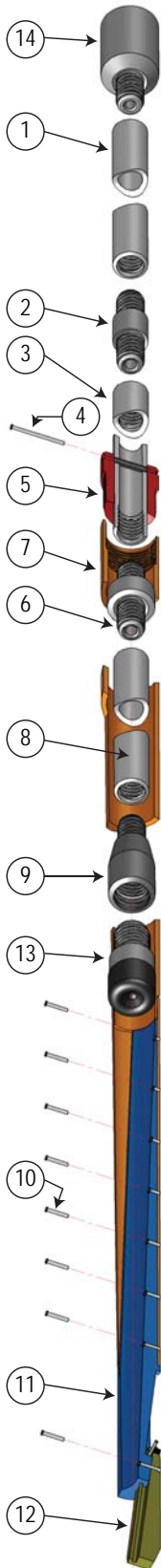

## H - Retrievable Wedge Assembly Full Assembly Part / 90-10-500 (Items 1 through 12)

TIME Limited's Retrievable Wedge assemblies are manufactured in Canada with 4140 steel, a heat treated, stress relieved material, to ensure the best quality product.

### Why do we use retrievable Wedges?

- Ideal for drill holes that need multiple wedge deflections
- Can be used directly off the bottom of the drill hole
- No steel is left at the bottom of the hole
- Reusable

**Before you use the assembly, ensure the bottom of the hole is flat by using the Solid Spindle Assembly and Dressing bit (not shown).**

H Solid Spindle Assembly	629-14
H Inner Tube Dressing Bit	627-16

### Using a Retrievable Wedge

- Lower wedge to the bottom of the hole
- Shear the pin on the locking wedge
- Shear the pin on the retrieving coupling
- Drill the concave bit passed the wedge blade
- Remove the entire wedge assembly by pulling the rods

To ensure the wedge assembly drills in the correct hole and follows the wedge deflection, drillers should not be overly cautious. It is recommended that the penetration rate and rotation speed be as fast as possible whilst operating within smooth drilling practices according to ground conditions. If the penetration rate is too slow the bit will tend to have a milling effect on the wedge increasing the possibility of drilling it out and not gaining the required amount of deflection.

Item	Qty	Description / Material	Size/Pt. No
1	1	10' BW Drill Rod (less coupling)	91-10-310
2	1	BW Rod Coupling	91-10-319
3	1	Wedging Barrel (2ft BW Rod)	629-07
4	1	Shear Pin, 5" Common Nail	625-49
5	1	Wedge Housing Collar	629-04
6	1	Retrieving Coupling	629-08
7	1	Wedge Housing	629-03
8	1	5' BW Drill Rod (less coupling)	91-10-305
9	1	Tapered Sub	629-09
10	8	Shear Pin, 4" Common Nail	625-50
11	1	Wedge Blade	629-00
12	1	Locking Wedge	629-01

The following items are not included in the assembly, but are supplied by TIME

13	1	NWC Concave Bit	629-13
14 A	1	Sub, HWL Rod Box to BW Rod Pin	93-55-502
14 B	1	Sub, HT Rod Box to BW Rod Pin	93-55-512



# Drilling Reamer - H Retrievable

## Assembly Diagram H - Retrievable Reamer

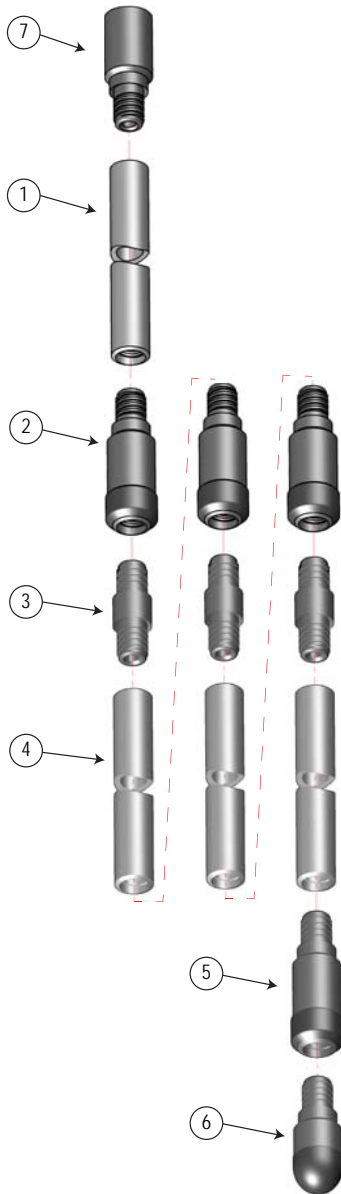

## H - Retrievable Reamer Assembly Full Assembly Part / 90-11-500 (Items 1 through 6)

TIME Limited's Retrievable Wedge assemblies are manufactured in Canada with 4140 steel, a heat treated, stress relieved material, to ensure the best quality product.

### Why do we use a reamer assembly?

- Ensures a smooth transition from the parent hole to the wedge deflection
- Ensures a smooth deflection in the drill hole
- Ensures hole is at the proper gauge diameter to continue coring
- Reusable

### Using a Retrievable Reamer

To ensure the reamer assembly functions properly, it is recommended that the penetration rate and rotation speed be as fast as possible whilst operating within smooth drilling practices. Additional bit pressure may be required to force the bull-nose bit and reamer assembly into the new hole.

Item	Qty	Description / Material	Size/Pt. No
1	1	5' NW Drill Rod (less coupling)	91-10-405
2	3	HNWC Reaming Bit	629-12
3	3	NW Rod Coupling	91-10-419
4	3	2' NW Drill Rod (less coupling)	91-10-402
5	1	HNWC Reaming Shell	629-11
6	1	HNWC Ball Bit	629-10
The following items are not included in the assembly, but are supplied by TIME			
7A	1	Sub, HWL Rod Box to NW Rod Pin	93-55-503
7B	1	Sub, HT Rod Box to NW Rod Pin	93-55-513

Please Note: TIME will make adapters to fit your thread specifications



# Drilling Wedges - P Retrievable

## Assembly Diagram P - Retrievable Wedge

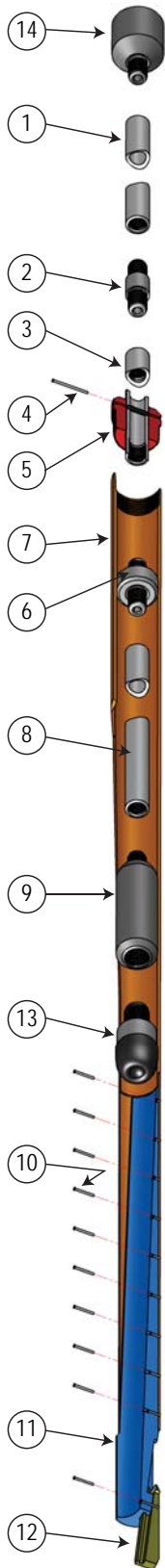

## P - Retrievable Wedge Assembly Full Assembly Part / 90-10-600 (Items 1 through 12)

TIME Limited's Retrievable Wedge assemblies are manufactured in Canada with 4140 steel, a heat treated, stress relieved material, to ensure the best quality product.

### Why do we use retrievable Wedges?

- Ideal for drill holes that need multiple wedge deflections
- Can be used directly off the bottom of the drill hole
- No steel is left at the bottom of the hole
- Reusable

**Before you use the assembly, ensure the bottom of the hole is flat by using the Solid Spindle Assembly and Dressing bit (not shown).**

P Solid Spindle Assembly	630-14
P Inner Tube Dressing Bit	627-17

### Using a Retrievable Wedge

- Lower wedge to the bottom of the hole
- Shear the pin on the locking wedge
- Shear the pin on the retrieving coupling
- Drill the concave bit passed the wedge blade
- Remove the entire wedge assembly by pulling the rods

To ensure the wedge assembly drills in the correct hole and follows the wedge deflection, drillers should not be overly cautious. It is recommended that the penetration rate and rotation speed be as fast as possible whilst operating within smooth drilling practices according to ground conditions. If the penetration rate is too slow the bit will tend to have a milling effect on the wedge increasing the possibility of drilling it out and not gaining the required amount of deflection.

Item	Qty	Description / Material	Size/Pt. No
1	1	10' BW Drill Rod (less coupling)	91-10-310
2	1	BW Rod Coupling	91-10-319
3	1	Wedging Barrel	629-07
4	1	Shear Pin, 5" Common Nail	625-49
5	1	Wedge Housing Collar	630-04
6	1	Retrieving Coupling	630-08
7	1	Wedge Housing	630-03
8	1	5' BW Drill Rod (less coupling)	91-10-305
9	1	Tapered Sub	630-09
10	10	Shear Pin, 4" Common Nail	625-50
11	1	Wedge Blade	630-00
12	1	Locking Wedge	630-01

The following items are not included in the assembly, but are supplied by TIME

13	1	HWC Concave Bit	630-13
14	1	Sub, HWT Rod Box to BW Rod Pin	93-55-612





# Drilling Reamer - P Retrievable

## Assembly Diagram P - Retrievable Reamer

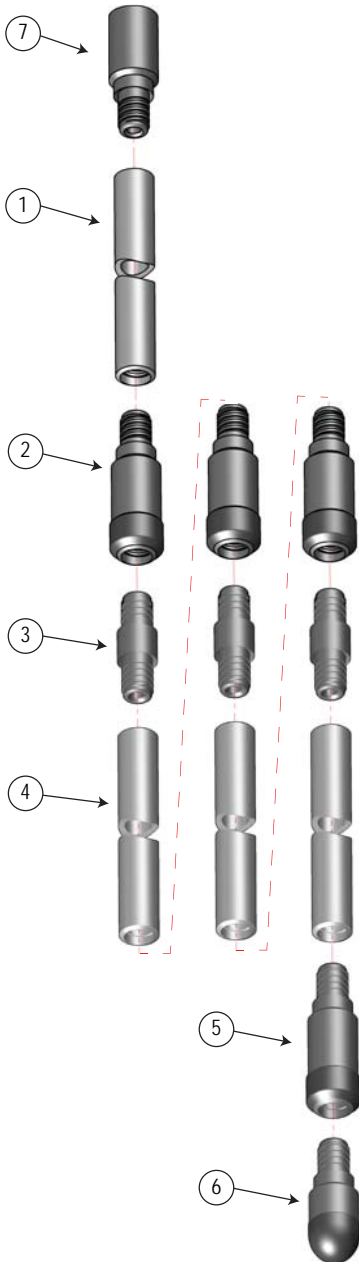

## P - Retrievable Reamer Assembly Full Assembly Part / 90-11-600 (Items 1 through 6)

TIME Limited's Retrievable Wedge assemblies are manufactured in Canada with 4140 steel, a heat treated, stress relieved material, to ensure the best quality product.

### Why do we use a reamer assembly?

- Ensures a smooth transition from the parent hole to the wedge deflection
- Ensures a smooth deflection in the drill hole
- Ensures hole is at the proper gauge diameter to continue coring
- Reusable

### Using a Retrievable Reamer

To ensure the reamer assembly functions properly, it is recommended that the penetration rate and rotation speed be as fast as possible whilst operating within smooth drilling practices. Additional bit pressure may be required to force the bull-nose bit and reamer assembly into the new hole.

Item	Qty	Description / Material	Size/Pt. No
1	1	5' NW Drill Rod (less coupling)	91-10-405
2	3	PNWC Reaming Bit	630-11
3	3	NW Rod Coupling	91-10-419
4	3	2' NW Drill Rod (less coupling)	91-10-402
5	1	PNWC Reaming Shell	630-10
6	1	PNWC Ball Bit	630-12
The following items are not included in the assembly, but are supplied by TIME			
7	1	Sub, HWT Rod Box to NW Rod Pin	93-55-613

Please Note: TIME will make adapters to fit your thread specifications



# Bypass Wedges & Parts

## Bypass Wedges & Parts

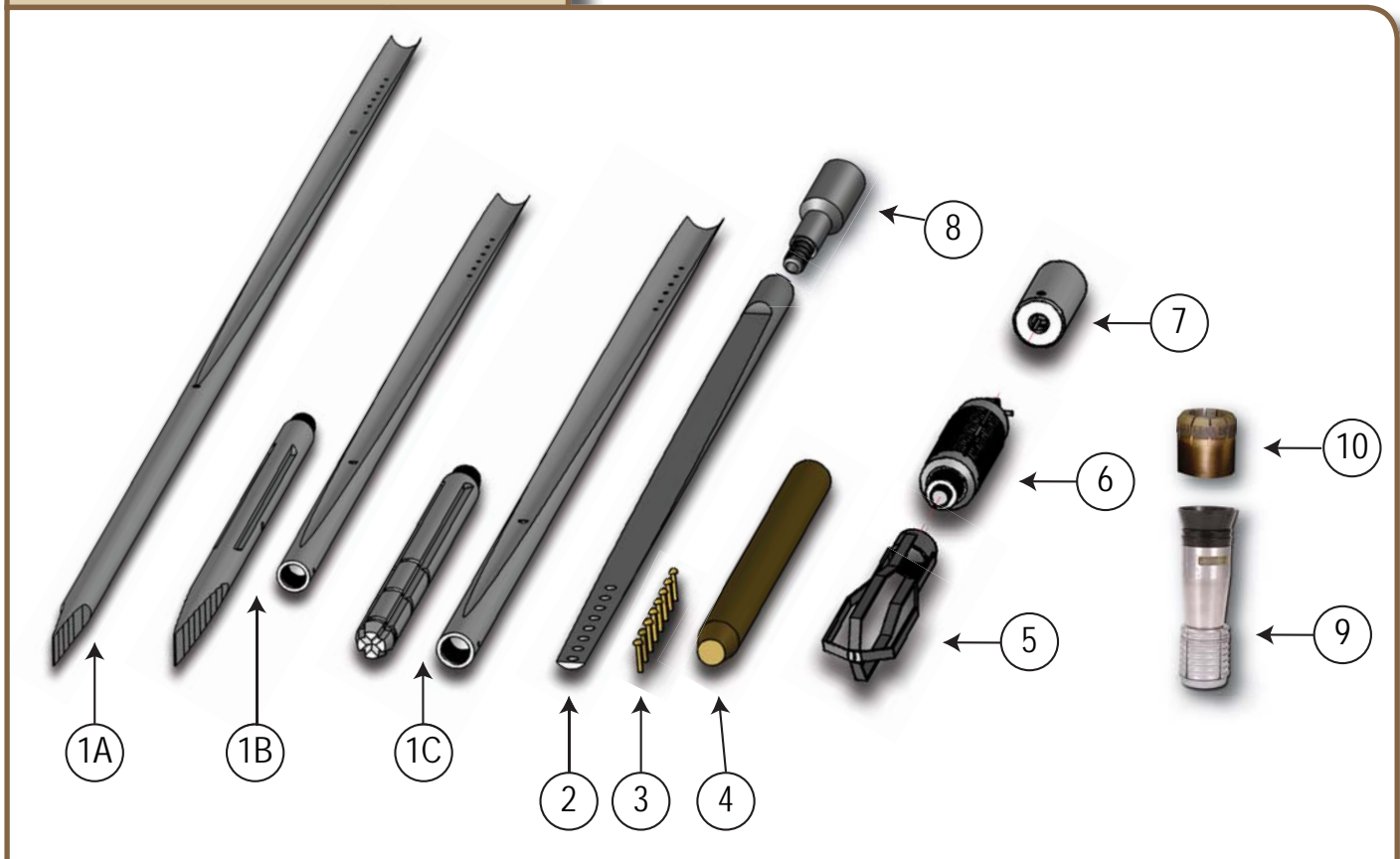

Number	Description	Product Number			
		"B"	"N"	"H"	"P"
Bypass Wedge Assemblies (Items 1-7)		90-09-300	90-09-400	90-09-500	90-09-600
1A	Bypass Chisel Wedge	595-00	596-00	597-00	598-00
1B	Bypass 2 Piece Chisel Wedge	595-00MAXE	596-00MAXE	597-00MAXE	598-00MAXE
1C	Bypass 2 Piece Blunt Wedge	595-00MGV	596-00MGV	597-00MGV	598-00MGV
2	Wedge Dropper	595-01	596-01	596-01	596-01
3	Copper Rivets, 5/16 X 2"	92-1008	92-1008	92-1008	92-1008
4	Wooden Plug	595-03	596-03	597-03	598-03
5	Steel Plug Basket	595-05	596-05	597-05	598-05
6	Wedge Plug with Pin	595-06	596-06	597-06	598-06
7	Rod Box to Wedge Plug Adapter	595-07	596-07	597-07	598-07
<b>Items Not Included in Assembly - Supplied by TIME</b>					
8	Wedge Dropper Adapter	93-55-302	93-55-403	93-55-503	93-55-613
9	Van Ruth Plug	409-01	409-03	409-02	409-04
10	Tapered Wedge Bit	PLT-WDG-B	PLT-WDG-N	PLT-WDG-H	PLT-WDG-P
11	Resin Epoxy	420-121			

When ordering TIME Limited's Bypass Wedge assemblies, you will need to choose either Wedge 1A, 1B, or 1C. You will need 1 each of items 2, 3, 4 and 8. Then you need to choose plug option 'A' (items 5, 6, 7) or plug option 'B' (item 9).



North America 1-800-669-3542  
International +1-705-647-8138

PAGE: WE10



www.timeltd.ca

# Drilling Wedges - Subs

## Sub, Water Swivel & Hoisting Plug



Part Number	Description
-------------	-------------

93-51-200	SUB EW R/P TO BW/L R/P
93-51-201	SUB AW R/P TO BW/L R/P
93-51-202	SUB AW R/P TO NW/L R/P
93-51-203	SUB AW R/P TO HW/L R/P
93-51-204	SUB AW R/P TO HWT R/P
93-51-211	SUB AW R/P TO BT R/P
93-51-212	SUB AW R/P TO NT R/P
93-51-214	SUB AW R/P TO HT R/P
93-51-215	SUB AW R/P TO HM R/P
93-51-301	SUB BW R/P TO BW/L R/P
93-51-302	SUB BW R/P TO NW/L R/P
93-51-303	SUB BW R/P TO HW/L R/P
93-51-304	SUB BW R/P TO HWT R/P
93-51-310	SUB BW R/P TO BT R/P
93-51-311	SUB BW R/P TO NT R/P
93-51-312	SUB BW R/P TO NM R/P
93-51-313	SUB BW R/P TO HT R/P
93-51-401	SUB NW R/P TO NW/L R/P
93-51-402	SUB NW R/P TO HW/L R/P
93-51-411	SUB NW R/P TO NT R/P
93-51-413	SUB NW R/P TO HT R/P

## Sub, Wedging and Fishing Tools



Part Number	Description
-------------	-------------

93-55-300	SUB BW/L R/B TO EW R/P
93-55-301	SUB BW/L R/B TO AW R/P
93-55-302	SUB BW/L R/B TO BW R/P
93-55-315	SUB BWL R/B TO AX R/P
93-55-310	SUB BT R/B TO EW R/P
93-55-311	SUB BT R/B TO AW R/P
93-55-312	SUB BT R/B TO BW R/P
93-55-401	SUB NW/L R/B TO AW R/P
93-55-401LG	SUB NW/L R/B TO AW R/P LRG BOR
93-55-402	SUB NW/L R/B TO BW R/P
93-55-402LG	SUB NW/L R/B TO BW R/P LRG BOR
93-55-403	SUB NW/L R/B TO NW R/P
93-55-417	SUB NW/L R/B TO NX R/P
93-55-411	SUB NT R/B TO AW R/P
93-55-412	SUB NT R/B TO BW R/P
93-55-413	SUB NT R/B TO NW R/P
93-55-501	SUB HW/L R/B TO AW R/P
93-55-502	SUB HW/L R/B TO BW R/P
93-55-503	SUB HW/L R/B TO NW R/P
93-55-511	SUB HT R/B TO AW R/P
93-55-512	SUB HT R/B TO BW R/P
93-55-513	SUB HT R/B TO NW R/P
93-55-611	SUB HWT R/B TO AW R/P
93-55-612	SUB HWT R/B TO BW R/P
93-55-613	SUB HWT R/B TO NW R/P

\*\* R/B = Rod Box R/P = Rod Pin \*\*



North America 1-800-669-3542

International +1-705-647-8138

PAGE: WE11



www.time ltd.ca

# Drilling Wedges - Sub Parts

## Sub, Casing



Part Number	Description
93-56-300	SUB BW/L R/B TO AW CSG/P
93-56-301	SUB BW/L R/B TO BW CSG/P
93-56-302	SUB BW/L R/B TO NW CSG/P
93-56-310	SUB BT R/B TO AW CSG/P
93-56-311	SUB BT R/B TO BW CSG/P
93-56-312	SUB BT R/B TO NW CSG/P
93-56-320	SUB BW CSG/B TO N BIT-THRD/P
93-56-321	SUB BW CSG/B TO NW/L R/P
93-56-322	SUB BW CSG/B TO NTW R/P
93-56-400	SUB NW/L R/B TO BW CSG/P
93-56-401	SUB NW/L R/B TO NW CSG/P
93-56-402	SUB NW/L R/B TO HWT CSG/P
93-56-410	SUB NT R/B TO BW CSG/P
93-56-411	SUB NT R/B TO NW CSG/P
93-56-412	SUB NT R/B TO HWT CSG/P
93-56-420	SUB NW CSG/B TO H BIT-THRD/P
93-56-421	SUB NW CSG/B TO HW/L R/P
93-56-422	SUB NW CSG/B TO HWT CSG/P
93-56-500	SUB HW/L R/B TO NW CSG/P
93-56-501	SUB HW/L R/B TO HWT CSG/P
93-56-502	SUB HW/L R/B TO PWT CSG/P
93-56-510	SUB HT R/B TO NW CSG/P
93-56-511	SUB HT R/B TO HWT CSG/P
93-56-512	SUB HT R/B TO PWT CSG/P
93-56-601	SUB HWT CSG/B TO PWT CSG/P
93-56-620	SUB HWT CSG/B TO PWL/BIT THRD
93-56-621	SUB PWT CSG/B TO PW CSG/P
93-56-622	SUB PW CSG/B TO PWT CSG/P

## Sub, Rod



Part Number	Description
93-52-100	SUB EX R/B TO EW R/P
93-52-101	SUB EX R/B TO EW R/B
93-52-200	SUB AW R/B TO EW R/P
93-52-201	SUB AW R/B TO BW R/P
93-52-202	SUB AW R/B TO AX R/P
93-52-210	SUB AX R/B TO AW R/P
93-52-300	SUB BW R/B TO AW R/P
93-52-301	SUB BW R/B TO NW R/P
93-52-400	SUB NW R/B TO BW R/P
93-52-410	SUB NX R/B TO BW R/P
--	
93-53-100	SUB EW R/P TO EW R/P
93-53-200	SUB AW R/P TO AW R/P
93-53-201	SUB AW R/P TO BW R/P
93-53-210LG	SUB AX R/P TO AW R/P LRG BORE
93-53-300	SUB BW R/P TO BW R/P
93-53-301	SUB BW R/P TO NW R/P
93-53-400	SUB NW R/P TO NW R/P
93-53-410	SUB NX R/P TO BW R/P

\*\* R/B = Rod Box R/P = Rod Pin \*\*



North America 1-800-669-3542

International +1-705-647-8138

PAGE: WE12



www.timeltd.ca

# Drilling Wedges - Rods/Couplings

## Conventional Rods and Couplings Parts Lists

### Conventional Rods

Part Number	Description
91-10-102	ROD EW 2'
91-10-105	ROD EW 5'
91-10-110	ROD EW 10'
91-10-201	ROD AW 1'
91-10-202	ROD AW 2'
91-10-204	ROD AW 4'
91-10-205	ROD AW 5'
91-10-206	ROD AW 6'
91-10-210	ROD AW 10'
91-10-211	ROD AW 11'4"
91-10-212	ROD AW 12'
91-10-202X	ROD AX 2'
91-10-204X	ROD AX 4'
91-10-205X	ROD AX 5'
91-10-210X	ROD AX 10'
91-10-211X	ROD AX 11'4"
91-10-301	ROD BW 1'
91-10-302	ROD BW 2'
91-10-305	ROD BW 5'
91-10-310	ROD BW 10'
91-10-401	ROD NW 1'
91-10-402	ROD NW 2'
91-10-405	ROD NW 5'
91-10-410	ROD NW 10'

### Rod Couplings

Part Number	Description
91-10-119	EW ROD CPLG
91-10-219	AW ROD CPLG
91-10-219LG	AW ROD CPLG LARGE BORE
91-10-219X	AX ROD CPLG LARGE BORE
91-10-319	BW ROD CPLG
91-10-319LG	BW ROD CPLG LARGE BORE
91-10-419	NW ROD CPLG
91-10-419LG	NW ROD CPLG LARGE BORE

## Conventional Rods and Couplings Pictures

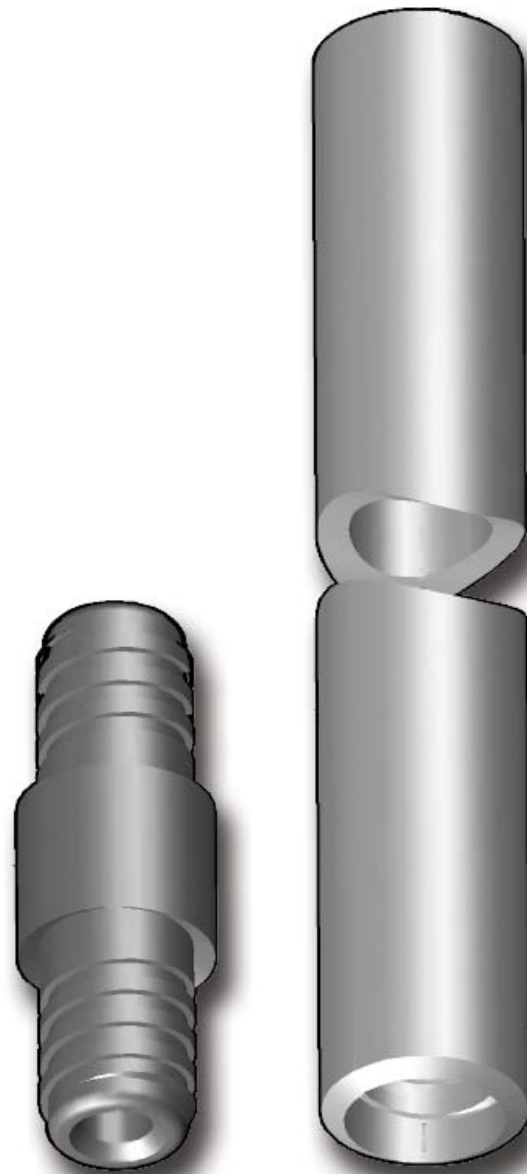

### Rod Description

Rods are available in various lengths (from 1' - 12') and thread profiles.

If you don't see the thread profile you are looking for, we have it, please contact us at **1-800-669-3542** or email [info@timeltd.ca](mailto:info@timeltd.ca).



# Manufacturing and Fabrication

## Design and Innovation

The TIME team takes pride in providing customers with quality products and the absolute best service with a personal touch.

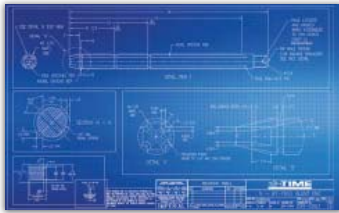

Not only does TIME distribute a number of quality product lines, we also manufacture a number of our own core products. In conjunction with our fabrication and machining capabilities, we have a team that has well over 250 years of experience in the mining, diamond drilling, and various industrial sectors. With the technical knowhow, we offer design capabilities specifically focused on new product development, innovative design, and problem solving.

We can manufacture to your requirements, or provide complete design and drafting expertise in-house.

RESPONDING TO CUSTOMER NEEDS

Our mandate is to exceed our customer's expectations.  
Peter R. Henderson, President

## MACHINING

TIME Limited's machining shop uses a combination of heavy duty, big and small bore lathes, CNC milling machines, CNC lathes and conventional lathes.



Here are some of our featured equipment and capabilities:



### Hurco TM-18 Heavy Duty Lathe

- a. Bar Capacity: 6.4 inch bar capacity
- b. Turning Diameter: 25 inch max
- c. Turning Length: 39.4 inch max
- d. Travel: 17x, 40z inch
- e. Quick Change air collect chuck system



### Nakamura-Tome WT300MMYS

- a. 9-axis, 2 turret multitasking machining
- b. Bar Capacity: 65mm (l) and 102mm (r)
- c. Turning diameter: 270mm max turning
- d. Turning length: 780mm max
- e. Quick Change air collect chuck system
- f. Chip Blaster GV2-40 high pressure coolant system

Other Machines include:  
CNC lathes such as ROMI M27 heavy duty big bore lathe and ROMI M20 small bore lathe, as well as a host of conventional lathes.

### Hurco VMX50 Milling Machine

- a. 3-axis milling machine
- b. Travel: 50 x 26 x 24 inch
- c. Table Size: 59 x 26 inch
- d. Tool Capacity: 30 CAT 50
- e. Magnetic Material Holder

CNC milling machines such as MAG Fadal VMC4020FX mill, and FIRST LC-185v-B milling machine, as well as a host of conventional milling machines



## Our Newest Toys!



## TIME OFFICES

We supply mine-grade products, manufacture quality products, offer design, fabrication and custom machining, as well as sourcing. We are your one-stop shop for industrial needs.

### Head Office

#### Haileybury

Tel: 705-647-8138 Fax: 705-647-9800

#### Sudbury

Tel: 705-524-8903 Fax: 705-524-9140

#### Val d'Or

Tel: 819-874-8138 Fax: 819-874-8139

#### Timmins

Tel: 705-268-8128 Fax: 705-268-5122

info@timeltd.ca www.timeltd.ca

## FABRICATION

TIME Limited's welding and fabrication shop has full capabilities for custom work. Our shop includes a large plasma table, capable of cutting material up to 8' X 20', 2 10,000 lbs SMH Overhead Cranes, an AKBEND ASM-S 17 roller and a brand new, iBend CNC Hydraulic Press Brake.



Our welding shop is certified by the Canadian Welding Bureau annually.



www.timeltd.ca



Serving the Mining Industry Since 1971

## Manufacturing and Fabrication



Our brand new, State of the art, 40,000 Sq. ft. Manufacturing, Fabrication and Warehousing facility

**705-647-8138**

www.timeltd.ca

## STOCKING WAREHOUSE



TIME Limited's philosophy is to stock what our customers need. If we don't have it, and you need it on a regular basis, just ask and we will do our best to add it to our ever-growing warehouse.

We carry everything from Health and Safety to Hand tools, mining and diamond drilling products, TIME branded hoses and Gates fittings.



TIME Limited also fixes or makes your hydraulic hoses while you wait.



North America 1-800-669-3542

International +1-705-647-8138

PAGE: WE 14



www.timeltd.ca

# Letter From The President



## *Letter from the President*

*TIME is committed to total customer service. We strive to keep this promise in many ways.*

*Total service means manufacturing to industry standards. TIME Manufacturing and Fabrication Division produces quality products, such as drill wedges, safety and grout plugs, pump assemblies, rod wrenches and custom tooling and equipment.*

*Total service means manufacturing to your specifications. Our shop personnel have long experience at custom machining and design engineering for the mining and drilling industry.*

*Total service means sourcing for the products you need at prices that are competitive and fair. We distribute only the best names in the industry such as FMC, Ridgid Tools, Gray Tools, Bestolife, Ambex, Gates Hydraulics, among others.*

*Total service means listening to our customers and working with them to develop new solutions, products, and innovations to make their jobs safer and more cost effective.*

*Our commitment to customers has resulted in innovations, new products and important changes. In recent years we have worked with our customers to develop an underground compressed air conservation system, an underground long-hole production drill, a hydraulic rod wrench, a biodegradable rod grease, and an improved camp heater to meet industry standards.*

*Our people are committed to help find solutions to your problems. We would be pleased to discuss how we can help you raise your production and save money.*

*TIME's capabilities are limited only by our customers' requirements.*

*Peter R. Henderson  
President*



North America 1-800-669-3542  
International +1-705-647-8138  
PAGE: WE15



[www.time ltd.ca](http://www.time ltd.ca)

# Drilling Wedges

## MINING

### HOSE & HOSE FITTINGS

Chicago Couplings  
Hose - air, water & hydraulic  
Minsup Fittings  
Hansen Couplings  
Punch-Lok Clamps  
TIME Hose Fittings  
Whipchek Hose Anchors



### LIGHTING

Dual beam & alignment lasers  
Airturbo Lamp  
LED Mine Strobe Light (MSHA)  
Cordless Miner's Cap Lamp  
Tunnel Lamp  
LED Flood Lights



### MINING PLUGS

Anchor Bolts  
Displacement Plugs  
Margo Plugs  
Drill Hole Plugs  
Stemming Plugs  
Van Ruth Plugs  
VK Grout Plugs



### BARRIER PROTECTION

Marcel Gate  
Barrier Protection  
Complete Remote Systems



## DRILLING

### PERCUSSIVE TOOLS

Tapered Equipment  
Drifting & Tunneling  
Bench & Long Hole  
Shanks



### DIAMOND DRILL TOOLS, FLUIDS & POLYMERS

Core Barrels  
Water Equipment  
Wedging Tools  
Recovery Tools  
Hoisting Equipment  
Bestolife Lubricants  
Ambex Anchoring Capsules  
Drilling Fluids  
Linseed Soap  
Rod Grease  
Citrus Degreaser



### BLAST HOLE PRODUCTS

PVC & Polyethylene Pipe  
Anti-Static Loading Hose  
Loading Bags  
Depth Gauges  
Drill Hole Marker Plugs  
Hi-Vis Drill Hole Marker Plugs  
Birdie Plugs  
Powder Plugs  
Blasting Wire  
CAB Wire Hangers



### VALVES

Brass Ball Valves  
Brass Water Valves  
Butterfly Valves  
Gate Valves  
Mine Header Valves  
Mortrol Valves  
Relief Valves



**TIME**  
www.time ltd.ca

## INDUSTRIAL

### PUMPS & PARTS

FMC (Bean) Pumps & parts  
FMC (Bean) Pump Assemblies  
Prattisoli KF Series pumps  
NOMAD Diaphragm Pumps



### ENVIRONMENT - HEALTH - SAFETY

CSA approved Miner's Boots  
Safety Glasses, Goggles, Visors  
Hand, Head & Hearing Protection  
Harnesses & Lanyards  
Sorbent Mats, Rolls, Socks, Booms & Pillows  
Spill Kits



### JOB SITE STORAGE EQUIPMENT

Tough and ultra-secure:  
Storage chests & cabinets  
Work benches  
Field stations



### MINING SUPPLIES

Atomizer Bars - 3' and 12'  
Black Iron Fittings & Nipples  
COXREEL Safety Reels  
Hand Tools  
Mine Hooks - H & S  
Mining Header Manifolds  
Muck Scoops  
Proptec Rotary Mister  
RIDGID Pipe Wrenches  
RIDGID Threading Machines  
Strapping - CARISTRAP, STRAPRITE



### HOISTING & LIFTING

Chain  
Loadbinders  
Poly Rope  
Shackles & hooks  
Sheave Blocks - 6" & 8"  
Wire Rope



[f](#) [t](#) [in](#)

**TIME**

8AM - 5PM EST / TELÉPHONE DE 8h À 17h (HNE), 705-647-8138

[Manufacturing & Fabrication](#)
[Resources](#)
[Services](#)
[Demander une soumission](#)
[Catalogue de produits](#)

[Mining](#)  
[Exploration](#)  
[Industrial](#)  
[Customization](#)  
[Distribution](#)  
[Manufacturing](#)  
[Innovations](#)

Brand New Website / Tout Nouveau Site Web

**www.time ltd.ca**

rev 04292016en



North America 1-800-669-3542  
International +1-705-647-8138

PAGE: WE16



www.time ltd.ca