

# Fluid & Air Transfer - Relief Valve

## TL Relief Valve

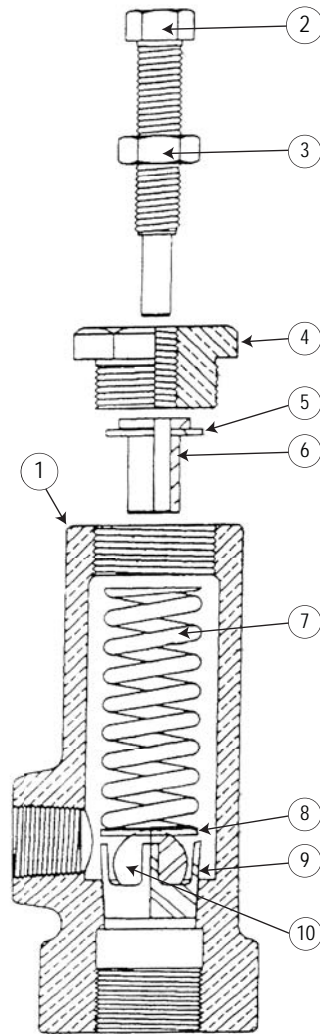

The TLRV TIME Ltd. Relief Valve is manufactured and assembled in Northern Ontario. This compact and robust valve has been tested to a recommended maximum hydrostatic pressure of 1200 PSI.

Dimensions: 8.5" high x 3" wide  
 Outlet Port: 3/4"  
 Inlet Port: 1"

Item	Description	Part #
	Relief Valve - Complete Assembly	210-01
1	Relief Valve body - Bare Machined	210-02
2	Adjustment screw	210-03
3	Locking nut	210-04
4	Plug	210-05
5	Spring guide washer - top	210-06
6	Spring guide	210-07
7	Compression spring	210-08
8	Spring guide washer - bottom (not shown)	210-06
9	Stainless steel valve seat	210-10
10	15/16" stainless steel ball	1187738

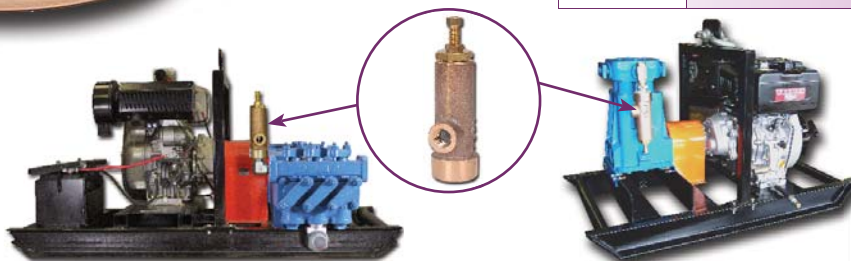

Relief Valve possible uses

